

Serie DTS-150

# Load capacity Up to 2.410 kg/pair

Full extension

Cross section 55,0 x 150,0 mm

## Material

Steel (C45E+C)  
galvanised  
milled airway

## DTS-...

one-way extension

## DTSB-...

two-way extension

## Info:

L = Length

TP = Travel path

LC = Load capacity at  
10,000 cycles

 Drill pattern

**SCHOCK**  
TELESCOPIC SLIDES

## DTS-150

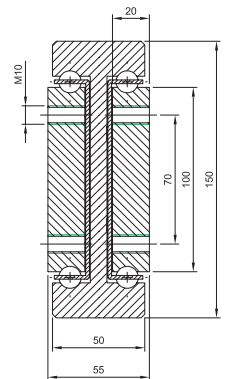
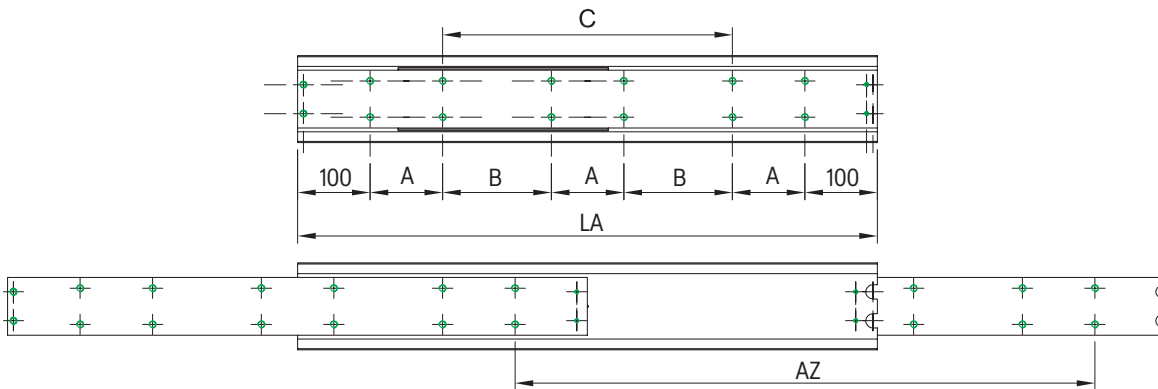

Article-Nr. DTS-150	LC in kg 10.000	L mm	TP mm	A mm	B mm	C mm	Weight - kg/piece. DTS-150
07000327001	1720	300	300	50	-	-	16,11
07000327002	1790	350	350	50	-	50	18,79
07000327003	1860	400	400	50	-	100	21,48
07000323004	1930	450	450	50	-	150	24,17
07000323005	2020	500	500	50	-	200	26,85
07000323006	2100	550	550	50	-	250	29,54
07000323007	2180	600	600	50	-	300	32,22
07000323008	2250	650	650	50	150	-	34,91
07000323009	2300	700	700	50	175	-	37,59
07000323010	2340	750	750	50	200	-	40,28
07000323011	2380	800	800	100	150	-	42,96
07000323012	2410	850	850	100	175	-	45,65
07000323013	2370	900	900	100	200	-	48,33
07000323014	2330	950	950	100	225	-	51,02
07000323015	2300	1000	1000	100	250	-	53,7
07000323016	2270	1050	1050	100	275	-	56,39
07000323017	2240	1100	1100	100	300	-	59,07
07000323018	2210	1150	1150	100	325	-	61,75
07000232019	2180	1200	1200	100	350	-	64,44
...	...	...	...	...	...	...	...
07000327045	380	3000	3000	100	1250	-	161,10

Serie DTS-150

**Load capacity Up to 2.410 kg/pair**

Full extension

Cross section 55,0 x 150,0 mm

Article-Nr. <b>DTS-150</b>		LC in kg 10.000	L mm	TP mm	A mm	B mm	C mm	Weight - kg/piece. <b>DTS-150</b>	
07000327001		1720	300	300	50	-	-	16,11	
07000327002		1790	350	350	50	-	50	18,79	
07000327003		1860	400	400	50	-	100	21,48	
07000327004		1930	450	450	50	-	150	24,17	
07000327005		2020	500	500	50	-	200	26,85	
07000327006		2100	550	550	50	-	250	29,54	
07000327007		2180	600	600	50	-	300	32,22	
07000327008		2250	650	650	50	150	-	34,91	
07000327009		2300	700	700	50	175	-	37,59	
07000327010		2340	750	750	50	200	-	40,28	
07000327011		2380	800	800	100	150	-	42,96	
07000327012		2410	850	850	100	175	-	45,65	
07000327013		2370	900	900	100	200	-	48,33	
07000327014		2330	950	950	100	225	-	51,02	
07000327015		2300	1000	1000	100	250	-	53,70	
07000327016		2270	1050	1050	100	275	-	56,39	
07000327017		2240	1100	1100	100	300	-	59,07	
07000327018		2210	1150	1150	100	325	-	61,75	
07000327019		2180	1200	1200	100	350	-	64,44	
07000327020		2150	1250	1250	100	375	-	67,12	
07000327021		2120	1300	1300	100	400	-	69,81	
07000327022		1990	1350	1350	100	425	-	72,50	
07000327023		1960	1400	1400	100	450	-	75,18	
07000327024		1920	1450	1450	100	475	-	77,86	
07000327025		1880	1500	1500	100	500	-	80,55	
07000327026		1840	1550	1550	100	525	-	83,24	
07000327027		1800	1600	1600	100	550	-	85,92	
07000327028		1760	1650	1650	100	575	-	88,61	
07000327029		1715	1700	1700	100	600	-	91,29	
07000327030		1660	1750	1750	100	625	-	93,98	
07000327031		1610	1800	1800	100	650	-	96,66	
07000327032		1550	1850	1850	100	675	-	99,35	
07000327033		1500	1900	1900	100	700	-	102,03	
07000327034		1450	1950	1950	100	725	-	104,72	
07000327035		1400	2000	2000	100	750	-	107,4	
07000327036		1300	2100	2100	100	800	-	112,77	
07000327037		1200	2200	2200	100	850	-	118,14	
07000327038		1100	2300	2300	100	900	-	123,51	
07000327039		1000	2400	2400	100	950	-	128,88	
07000327040		900	2500	2500	100	1000	-	134,25	
07000327041		780	2600	2600	100	1050	-	139,62	
07000327042		680	2700	2700	100	1100	-	144,99	
07000327043		580	2800	2800	100	1150	-	150,36	
07000327044		480	2900	2900	100	1200	-	155,73	
07000327045		380	3000	3000	100	1250	-	161,10	