

Serie QSRT-70

Load capacity Up to 310 kg/pair

Over extension

Cross section 35,0 x 70,0 mm

Material

Steel (C45E+C)
galvanised
milled airway

QSRT-...

one-way extension

QSRT-70

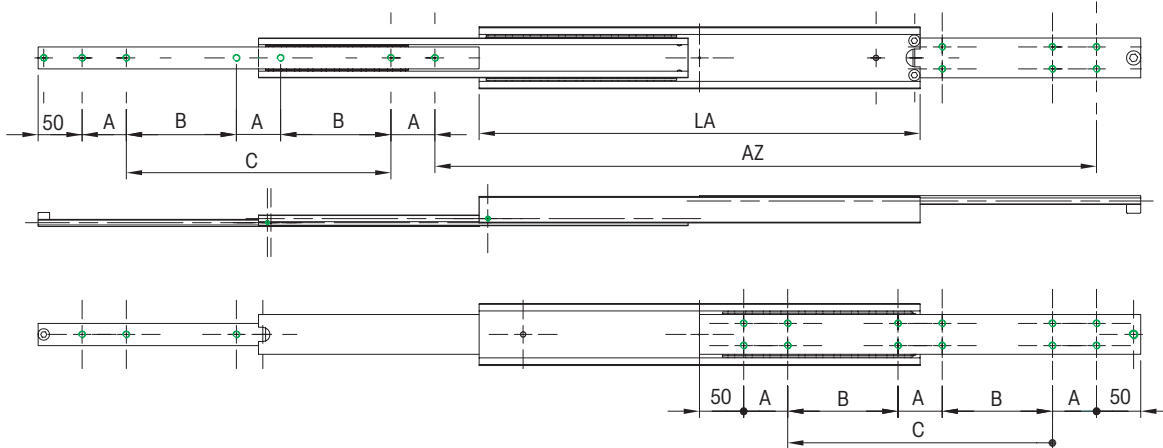

Info:

- L = Length
- TP = Travel path
- LC = Load capacity at 10,000 cycles
-  Drill pattern

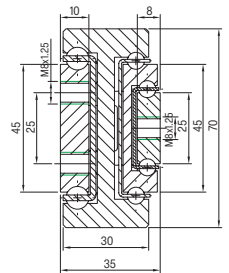

Article-Nr. QSRT-70	LC in kg 10.000	L mm	TP mm	A mm	B mm	C mm	Weight - kg/piece. QSRT-70
07000345001	260	300	450	50	-	100	4,17
07000345002	270	350	525	50	-	150	4,87
07000345003	280	400	600	50	-	200	5,56
07000345004	285	450	675	50	-	250	6,26
07000345005	295	500	750	50	-	300	6,95
07000345006	305	550	825	50	150	-	7,65
07000345007	310	600	900	50	175	-	8,34
07000345008	300	650	975	50	200	-	9,04
07000345009	290	700	1050	50	225	-	9,73
07000345010	280	750	1125	50	250	-	10,43
07000345011	270	800	1200	50	275	-	11,12
07000345012	260	850	1275	50	300	-	11,82
07000345013	250	900	1350	50	325	-	12,51
07000345014	240	950	1425	50	350	-	13,21
07000345015	230	1000	1500	50	375	-	13,90
07000345016	210	1050	1575	50	400	-	14,60
07000345017	200	1100	1650	50	425	-	15,29
07000345018	190	1150	1725	50	450	-	15,99
07000345019	180	1200	1800	50	475	-	16,68
...
07000345027	100	1600	2400	50	675	-	22,24

Serie QSRT-70

Load capacity Up to 310 kg/pair

Over extension

Cross section 35,0 x 70,0 mm

Article-Nr. QSRT-70		LC in kg 10.000	L mm	TP mm	A mm	B mm	C mm	Weight - kg/piece. QSRT-70	
07000345001		260	300	450	50	-	100	4,17	
07000345002		270	350	525	50	-	150	4,87	
07000345003		280	400	600	50	-	200	5,56	
07000345004		285	450	675	50	-	250	6,25	
07000345005		295	500	750	50	-	300	6,95	
07000345006		305	550	825	50	150	-	7,65	
07000345007		310	600	900	50	175	-	8,34	
07000345008		300	650	975	50	200	-	9,04	
07000345009		290	700	1050	50	225	-	9,73	
07000345010		280	750	1125	50	250	-	10,43	
07000345011		270	800	1200	50	275	-	11,12	
07000345012		260	850	1275	50	300	-	11,81	
07000345013		250	900	1350	50	325	-	12,51	
07000345014		240	950	1425	50	350	-	13,21	
07000345015		230	1000	1500	50	375	-	13,90	
07000345016		210	1050	1575	50	400	-	14,60	
07000345017		200	1100	1650	50	425	-	15,29	
07000345018		190	1150	1725	50	450	-	15,98	
07000345019		180	1200	1800	50	475	-	16,68	
07000345020		170	1250	1875	50	500	-	17,38	
07000345021		160	1300	1950	50	525	-	18,07	
07000345022		150	1350	2025	50	550	-	18,77	
07000345023		140	1400	2100	50	575	-	19,46	
07000345024		130	1450	2175	50	600	-	20,16	
07000345025		120	1500	2250	50	625	-	20,85	
07000345026		110	1550	2325	50	650	-	21,55	
07000345027		100	1600	2400	50	675	-	22,24	